

Rev 1.0  
2025

# GEMINI

CPO Manual

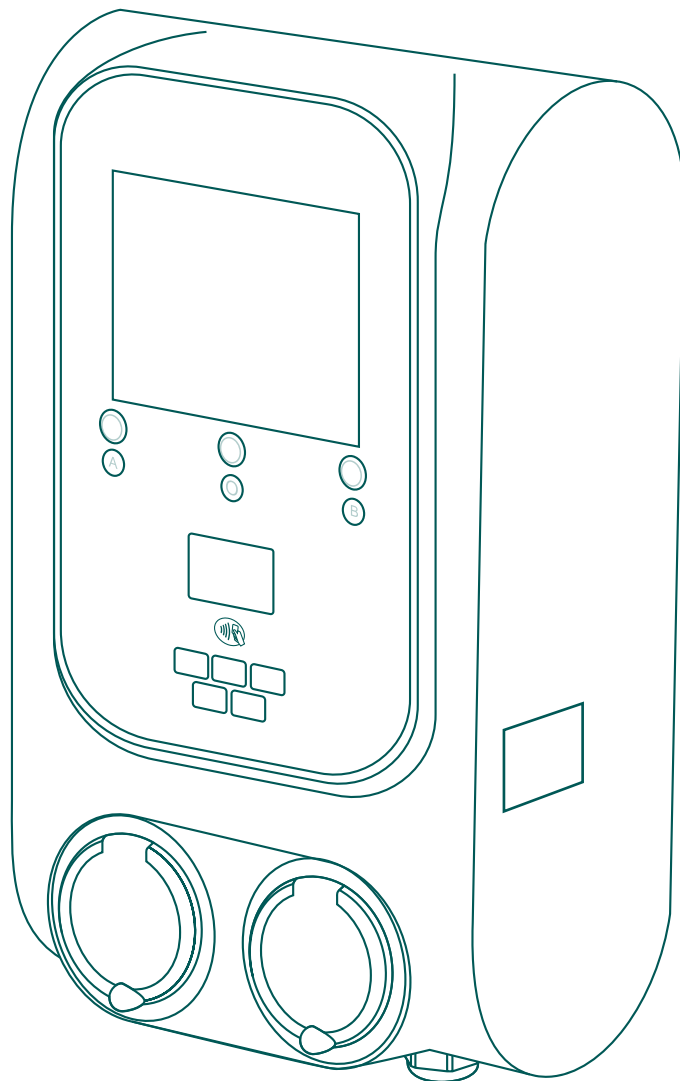

**Gemini**  
**Gemini Lite**  
**Gemini PRO**

PUBLIC OPERATIONAL  
CHARGING STATION

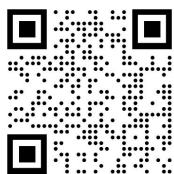

[www.raedian.com](http://www.raedian.com)

**RAEDIAN**

|           |   |          |
|-----------|---|----------|
| <b>1.</b> | <b>Disclaimer and safety warning</b>                          | <b>2</b> |
| 1.1       | Disclaimer  | 2        |
| 1.2       | Improper use  | 2        |
| 1.3       | Copyright   | 2        |
| 1.4       | Trademarks  | 2        |
| 1.5       | Languages   | 2        |
| 1.6       | Purpose and intended audience                                 | 2        |
| 1.7       | Explanation of text instructions used                         | 2        |
| 1.8       | Safety symbols  | 3        |
| 1.9       | General safety  | 3        |
| <b>2.</b> | <b>Using RFID card or contactless payment terminal</b>        | <b>4</b> |
| 2.1       | Purchase Raedian RFID card                                    | 4        |
| 2.2       | Use the Nebula system to pair the card with the charger       | 4        |
| 2.3       | Configure the RFID card tariffs for the station               | 5        |
| 2.4       | Charging using contactless payment terminals                  | 5        |
| <b>3.</b> | <b>Implementing dynamic load management by using HDLM Kit</b> | <b>6</b> |
| 3.1       | Preparation   | 6        |
| 3.2       | Configure the meter by using the Install APP                  | 6        |
| 3.3       | Add the leader charger  | 6        |
| 3.4       | Add follower chargers   | 6        |
| <b>4.</b> | <b>Connecting to a third-party OCPP</b>                       | <b>6</b> |

# 1.Disclaimer and safety warning

## 1.1 Disclaimer

The information in this document is for information purpose only, is provided as is, and may be subject to change without notice. Although RAEDIAN has made its best efforts to keep the document as precise and up-to-date as possible, RAEDIAN including its subsidiaries doesn't assume any liability for the correctness or completeness of the document and is not liable or responsible for the defects and damages resulting from the use of the information contained herein.



### NOTE

This document is subject to updates and changes. Errors and omissions are exceptional.

Any deviation to RAEDIAN's assembled products, including but not limited to, specific modifications to the product, such as stickers and its place, or application of different colors (collectively referred to as "Customization"), may affect the product, its experience, appearance, quality, and/or lifespan (Customized Product). RAEDIAN is not liable for any damage to, or caused by, the Customized Product if this damage is due to applied Customization.

RAEDIAN waives all liability and claims for compensation such as any type of damage, warranty of the product and the accessories in the following cases:

- Failure to comply with the general instructions and specific operating conditions in this manual.
- Improper use.
- External damage.
- Failures from the grid or the 4G service provider.
- Installation, commission, activation, or faulty repair or maintenance performed by unqualified person.
- Modification or configuration of the product or accessories without the knowledge of RAEDIAN.
- Use of the charging station outside the operational conditions specified in this manual.
- Use of spare parts not approved or produced by RAEDIAN.
- Events beyond RAEDIAN's control (force majeure).
- Malfunction of an open charge point back office.
- Damage to the electrical vehicle.

## 1.2 Improper use

The charging station is safe when used as intended. Any other use or modifications to the charging station are considered improper use and therefore not allowed.

Operators, owners, or qualified technicians are responsible for any personal injury or material damage caused by improper use.

## 1.3 Copyright

The reproduction, distribution, and application of this document, as well as the communication of its contents to other parties without explicit authorization from RAEDIAN or

any of its affiliates, are strictly prohibited. Any permitted use shall always be done in accordance with good practice and ensure that no harm may be caused to Raedian or by misleading the consumer.

## 1.4 Trademarks

**RAEDIAN®** is trademark registered by RAEDIAN. Any unauthorized use of this trademark is, therefore, illegal.

## 1.5 Languages

The English version of this document is the original source. Documentation in other languages are translations of this source. If any ambiguity or deviation among different languages, it shall be subject to English version.

## 1.6 Purpose and intended audience

This manual is applicable to GEMINI produced by Raedian. GEMINI is intended exclusively for charging electric vehicles and, when installed correctly, may be used by untrained individuals. Follow this manual to install and commission the charging station correctly.

Installation, commissioning and maintenance of this charging station must only be carried out by a qualified electrician. It is essential that the qualified technician has: Expertise on all relevant general and specific rules regarding safety and incident prevention.

Comprehensive knowledge of applicable electrical regulations.

The ability to identify risks and avoid potential hazards. Received and read these installation and operation instructions.

## 1.7 Explanation of text instructions used

Safety warnings and precautions in this document are as follows:



### DANGER

Signal word used to indicate an imminent or serious injury.



### WARNING

Signal word used to indicate a potentially hazardous situation which, if not avoided, could cause death or serious injury.



### CAUTION

Signal word used to indicate a potentially hazardous situation which, if not avoided, could cause minor or moderate injury.

# 1. Disclaimer and Safety Warning



## NOTE

Signal word used to provide additional information or information on possible product damage.

## 1.8 Safety symbols

The following warning pictograms are attached to (parts of) the charger:



**Dangerous voltage**



**Protective earth**

## 1.9 General safety

When installing or using the charging station, please follow below safety regulations:



### DANGER

Do not install or use the charging station near explosive or highly flammable materials.



### DANGER

Do not use the charging station if it is partially submerged in water.



### DANGER

Do not install or use the charging station if it is damaged, or if the plugs and cables are defective. Contact the charge point operator to repair any defects immediately.



### DANGER

Keep children and individuals who are unable to assess the risks associated with using this product away.

More extensive safety information can be found in the relevant sections of this document.

## 2. Using Raedian RFID card or contactless payment terminal

### 2.1 Purchase Raedian RFID card

Purchase Raedian RFID card (Please contact local Raedian distributor)

After purchasing the card, check the front and back of the card for the printed 10-digit number.

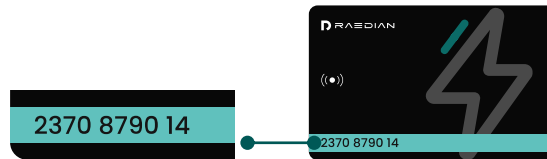

### 2.2 Use the Nebula system to pair the card with the charger

- If you haven't registered a Nebula account yet, first log in to <https://nebula.raedian.com/> to register (email registration required).
- If you haven't set up a station under your account yet, create one first.
- Add chargers to the station (1. you need both the socket code and its PIN code. 2. Here the socket code ends with A or B, i.e. EB1407DA-socket A, EB1407DB-socket B).

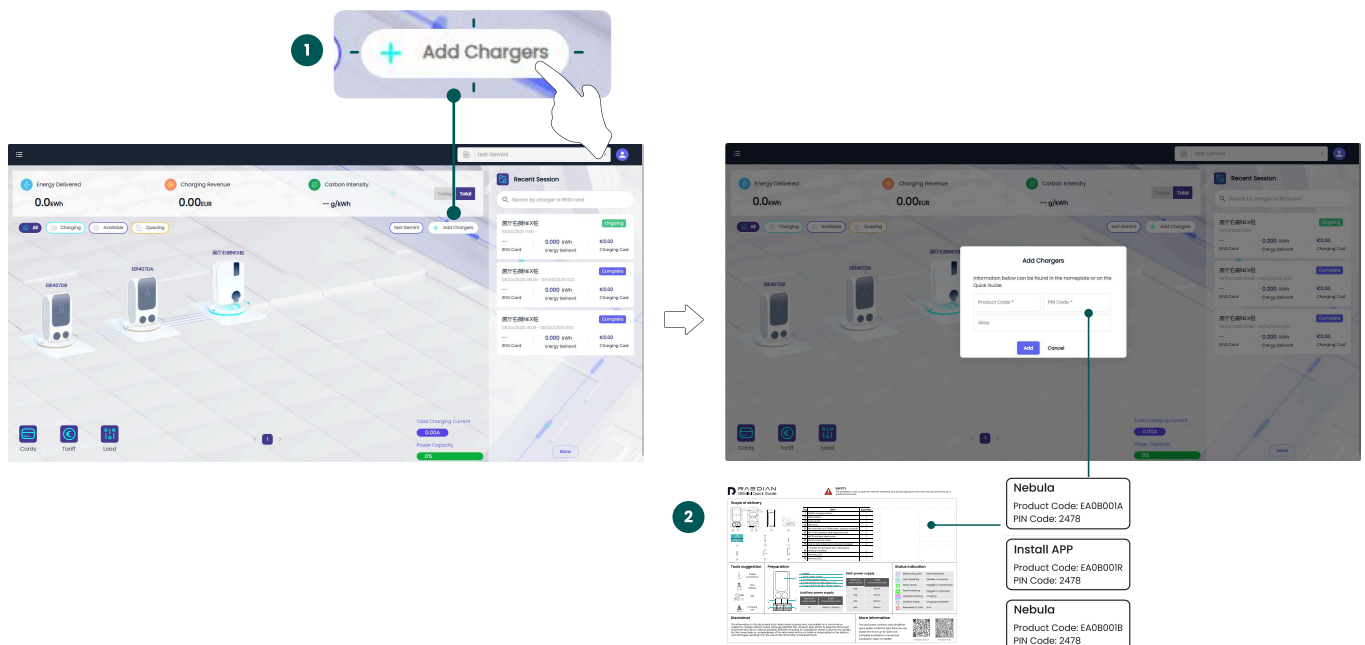

- Add the RFID card to the station (in principle, one RFID card can be only added to one station).

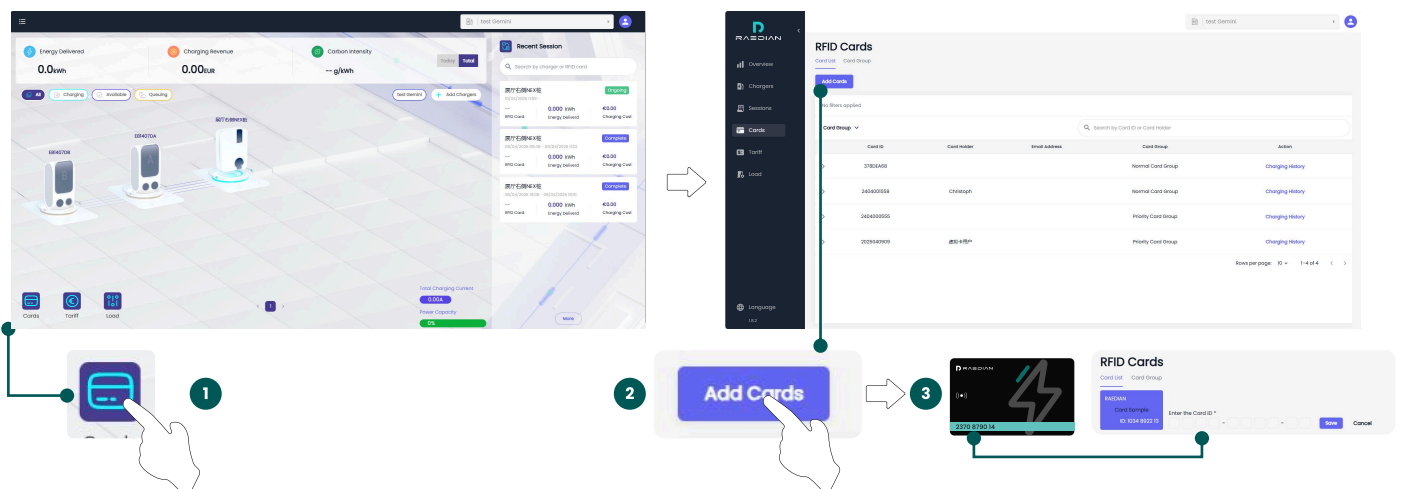

## 2. Using Raedian RFID card or contactless payment terminal

### 2.3 Configure the RFID card tariffs for the station

- Different RFID cards can be assigned to different groups, and each group can have its own tariff.
- Under Tariff Setting section, set “Price per kWh” with static price model.

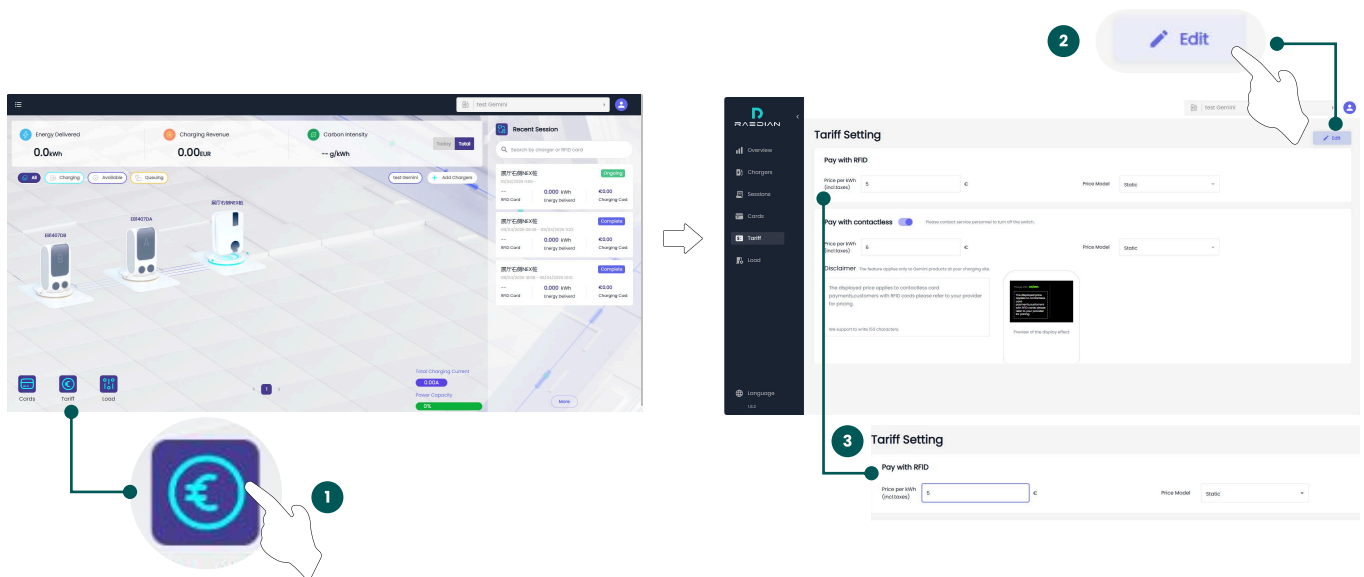

- Under RFID card section, choose card group, and set the tariff rate for each group.
- $\text{Tariff} = \text{static Tariff} \times \text{tariff rate}$

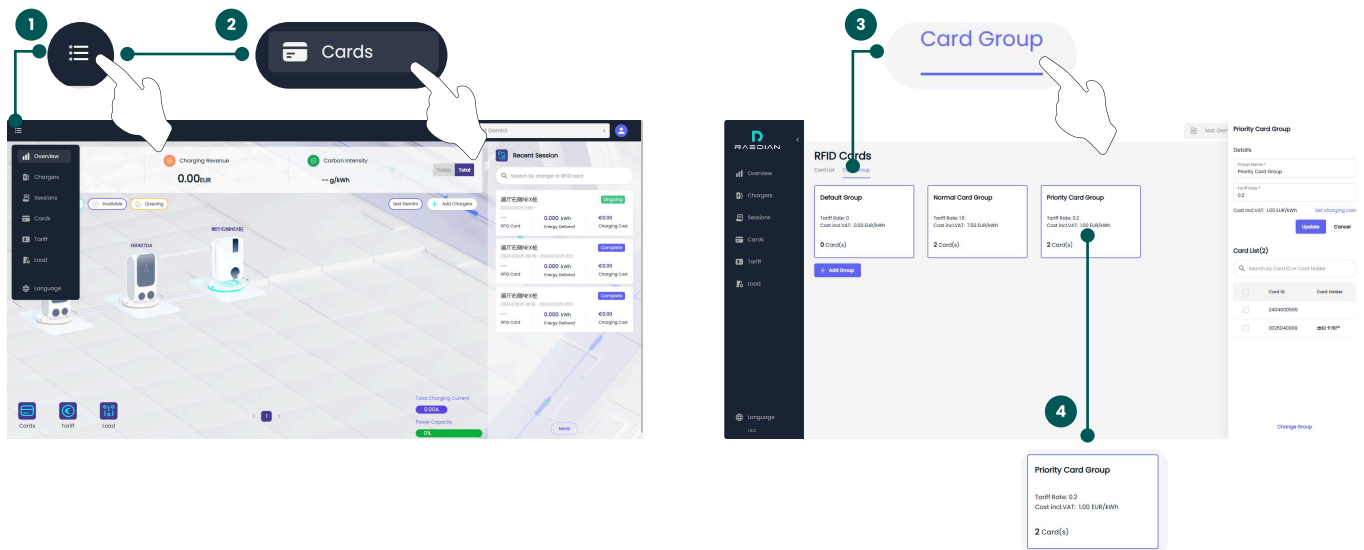

### 2.4 Use contactless payment terminals

#### Registration and Account Activation for Contactless Payment Terminals

- For the registration and account activation of Nayax or Payter P66 contactless payment terminals, please refer to the Onboarding Process.

#### Configuring Pricing Rates in the Nebula System

- Please contact Raedian and provide your Nebula username—Raedian will handle the rate configuration for you

## 3. Implementing dynamic load management using HDLM Kit

### 3.1 Preparation

- If the HDLM Kit has not been installed yet, refer to the HDLM Kit Quick Guide to install it properly.
- Before configuration, ensure you have all the charger codes and their corresponding PIN Codes (Here the charger code ends with R, i.e. EB1407DR).

### 3.2 Configure the meter by using the Install APP

1. In the Install APP, select the HDLM option from the initial page and create a new station (enter station name, address, and other details).
2. Create a group (group name, number of chargers in the group – max 16 chargers per group), then input the group's total power capacity(current).
3. Add the HDLM Kit code (the 14-digit number on the smart meter) to the APP.
4. Follow the Install APP indicates to verify whether the meter readings are correct.

### 3.3 Add the leader charger

- Each group can have only one Leader charger.
- Select a connection method between the Leader and HDLM Kit (RS485 or Wireless-LoRa).
- Verify that the Leader's readings match the HDLM Kit's readings.
- When adding, search for the charger code and enter the correct PIN Code.
- After successful addition, check the top-left corner of the Gemini Leader screen for an "L" indicator.
- If it shows "L!", the setup failed – please reconfigure.

### 3.4 Add follower chargers

- Verify the connection between each Follower and the Leader.
- After adding, check the top-left corner of the Gemini Follower screen for an "F" indicator.
- If it shows "F!", the setup failed – please reconfigure.
- Repeat the process for all remaining Followers until the last one is successfully added.

## 4. Connecting to a third-party OCPP

In the Install APP, select OCPP option from the initial page. Search for the corresponding charger code and enter the correct PIN CODE.

Note: The charger code should end with the letter "R".

From the list of available OCPP profiles, select the profile name you want to connect to.

Once connected successfully, the Install APP will display "Accepted".

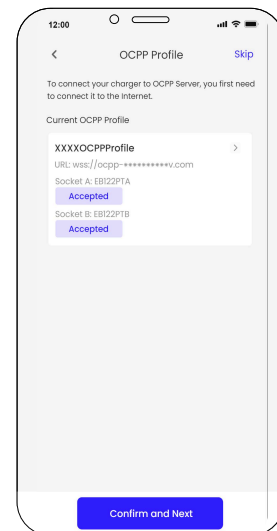

If the desired third-party OCPP is not shown in the existing OCPP profile list, you can add a new profile through the Install APP (you will need to input the Profile Name and OCPP URL). After adding it, you can proceed to connect.

If the connection is rejected, please contact Raedian to confirm whether the profile has been integrated.



Zhejiang RAEDIAN New Energy Technology Co., Ltd  
No.3, Shuangbai Road, Yuanhua Town, Haining City  
Zhejiang, 314416  
China